



Tips for install:

Separate Sensors (custom system):

The measurements suggested in the main instructions are for the 'optimum' position of the sensors on standard vehicles (cars, small vans etc). However, on larger vehicles, motor-homes & caravans, the sensors can be positioned in different locations as long as they are within the following guidelines and the correct 'sensor gasket' is used.

The sensors can be at different heights as long as the inner (black back) and outer (blue back) pairs are at the same height.

Optimum: 500mm – 600mm from the ground on a flat panel.
Gasket used: Straight gasket Nr8

Available: Absolute minimum 400mm up to 500mm from the ground
Gasket used: Angled gasket Nr9 to angle the sensors 10 degrees up

Available: 600mm – 700mm+ from the ground
Gasket used: Angled gasket Nr9 to angle the sensors 10 degrees down

Spread of the sensors:

Optimum: **ONLY ON STANDARD VEHICLES !** 250mm (inner black back sensors)
600mm (outer Blue back sensors) from the centre of the vehicle.

Available: 250mm – 310mm from the centre, (black back) recommended for motor-homes & caravans.
600mm – 720mm from the centre, (blue back) recommended for motor-homes & caravans.

Profile System:

Optimum: 500mm – 600mm from the ground on a flat panel.
Suggest mount onto the panel / bumper without brackets supplied.

Available: Absolute minimum 300mm up to 500mm from the ground
Must use the adjustable brackets supplied to angle the profile up from the ground by at least 10 degrees or more.

Available: 600mm & above from the ground
Must use the adjustable brackets supplied to angle the profile down towards the ground to a maximum of 10 degrees.

KIT CONTENTS

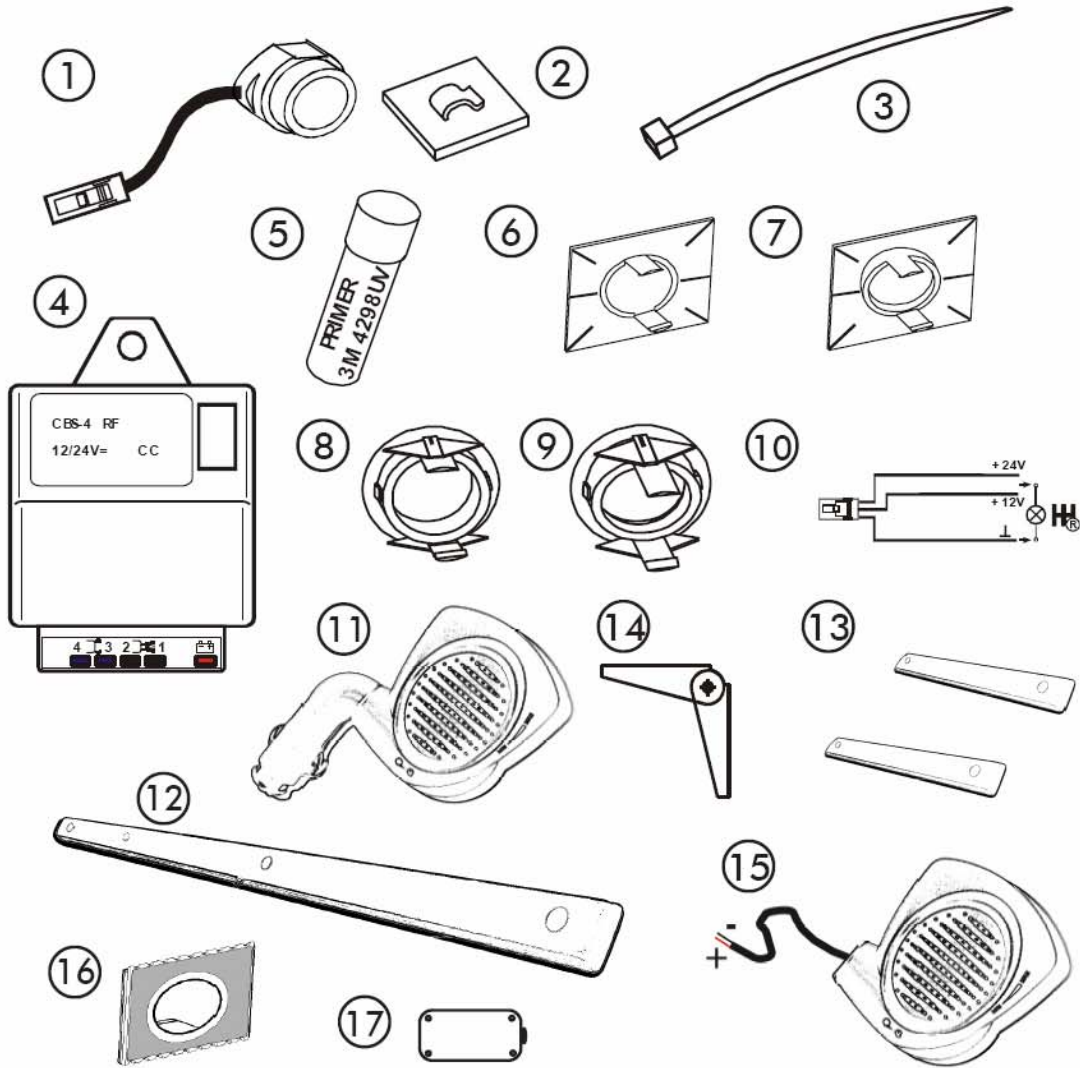

	Kit Components	Custom Kit	One Piece Profile Kit	Two Piece Profile Kit
1	Sensors	4		
2	Cable holders	4		4
3	Cable ties	10		10
4	Transmitter control unit	1		1
5	Primer	1		1
6	Flush rear sensor holder	4		
7	Angled rear sensor holder	4		
8	Front flush sensor holder	4		
9	Front angled sensor holder	4		
10	Transmitter control unit loom	1		
11	Receiver unit	1	1	1
12	One piece profile with sensors and transmitter control unit		1	
13	Two piece profile with sensors			2
14	Profile mounting brackets with fixings		3	4
15	Receiver unit loom (Optional)	4003RXW	4003RXW	4003RXW
16	Metal bumper inserts (Optional)	PPADI-1	N/A	N/A
17	Waterproof box (Optional)	4003RTB	N/A	4003RTB